

Site Inventory Form

State Historical Society of Iowa

(November 2005)

State Inventory No. 92-00585

New Supplemental

Part of a district with known boundaries (enter inventory no.) 92-00349

Relationship: Contributing Noncontributing

Contributes to a potential district with yet unknown boundaries

National Register Status:(any that apply) Listed De-listed NHL DOE

9-Digit SHPO Review & Compliance (R&C) Number _____

Non-Extant (enter year) _____

1. Name of Property

historic name Washington County Jail and Sheriff's Residence

other names/site number Downtown Survey Map # DT-116

2. Location

street & number 221 West Second Street

city or town Washington

vicinity, county Washington

Legal Description: (If Rural) Township Name _____ Township No. _____ Range No. _____ Section _____ Quarter of Quarter _____

(If Urban) Subdivision Original Plat Block(s) 7 Lot(s) Lots 3 & 4

3. State/Federal Agency Certification [Skip this Section]

4. National Park Service Certification [Skip this Section]

5. Classification

Category of Property (Check only one box)

- building(s)
- district
- site
- structure
- object

Number of Resources within Property

If Non-Eligible Property

Enter number of:

— buildings
 — sites
 — structures
 — objects
 — Total

If Eligible Property, enter number of:

Contributing	Noncontributing
<u>2</u>	—
—	—
—	—
—	—
<u>2</u>	—

Name of related project report or multiple property study (Enter "N/A" if the property is not part of a multiple property examination).

Title _____

Historical Architectural Data Base Number _____

6. Function or Use

Historic Functions (Enter categories from instructions)

04C01: police station

04C02: jail

01: Domestic

Current Functions (Enter categories from instructions)

04E: government office – 911 communications

7. Description

Architectural Classification (Enter categories from instructions)

Materials (Enter categories from instructions)

foundation 10B: poured concrete

walls (visible material) 10A: block 03: brick

roof 08B: rolled asphalt

other _____

Narrative Description SEE CONTINUATION SHEETS, WHICH MUST BE COMPLETED

8. Statement of Significance

Applicable National Register Criteria (Mark "x" representing your opinion of eligibility after applying relevant National Register criteria)

- Yes No More Research Recommended
- Yes No More Research Recommended
- Yes No More Research Recommended
- Yes No More Research Recommended

- A Property is associated with significant events.
- B Property is associated with the lives of significant persons.
- C Property has distinctive architectural characteristics.
- D Property yields significant information in archeology or history.

County Washington Address 221 West Second Street
City Washington

Site Number 92-00585
District Number 92-00349

Criteria Considerations

- A Owned by a religious institution or used for religious purposes.
- B Removed from its original location.
- C A birthplace or grave.
- D A cemetery
- E A reconstructed building, object, or structure.
- F A commemorative property.
- G Less than 50 years of age or achieved significance within the past 50 years.

Areas of Significance (Enter categories from instructions)

02: Architecture
26: Politics/government

Significant Dates

Construction date 1965-66 check if circa or estimated date
Other dates, including renovation _____

Significant Person

(Complete if National Register Criterion B is marked above)

Architect/Builder

Architect Powers and Associates (Iowa City)
Builder _____

Narrative Statement of Significance (SEE CONTINUATION SHEETS, WHICH MUST BE COMPLETED)

9. Major Bibliographical References

Bibliography See continuation sheet for citations of the books, articles, and other sources used in preparing this form

10. Geographic Data

UTM References (OPTIONAL)

Zone	Easting	Northing	Zone	Easting	Northing
1	_____	_____	2	_____	_____
3	_____	_____	4	_____	_____

See continuation sheet for additional UTM references or comments

11. Form Prepared By

name/title Stacy A. Nielsen, volunteer Rebecca L. McCarley, consultant, Davenport
organization Washington Historic Preservation Commission date May 6, 2012
street & number City Hall – 215 E. Washington St telephone 319-653-6584
city or town Washington state Iowa zip code 52353

ADDITIONAL DOCUMENTATION (Submit the following items with the completed form)

FOR ALL PROPERTIES

- Map:** showing the property's location in a town/city or township.
- Site plan:** showing position of buildings and structures on the site in relation to public road(s).
- Photographs:** representative black and white photos. If the photos are taken as part of a survey for which the Society is to be curator of the negatives or color slides, a photo/catalog sheet needs to be included with the negatives/slides and the following needs to be provided below on this particular inventory site:

Roll/slide sheet #	_____	Frame/slot #	_____	Date Taken	_____
Roll/slide sheet #	_____	Frame/slot #	_____	Date Taken	_____
Roll/slide sheet #	_____	Frame/slot #	_____	Date Taken	_____

- See continuation sheet or attached *photo & slide catalog sheet* for list of photo roll or slide entries.
- Photos/illustrations without negatives are also in this site inventory file.

FOR CERTAIN KINDS OF PROPERTIES, INCLUDE THE FOLLOWING AS WELL

- Farmstead & District:** (List of structures and buildings, known or estimated year built, and contributing or noncontributing status)
- Barn:**
 - A sketch of the frame/truss configuration in the form of drawing a typical middle bent of the barn.
 - A photograph of the loft showing the frame configuration along one side.
 - A sketch floor plan of the interior space arrangements along with the barn's exterior dimensions in feet.

State Historic Preservation Office (SHPO) Use Only Below This Line

Concur with above survey opinion on National Register eligibility: Yes No More Research Recommended
 This is a locally designated property or part of a locally designated district.

Comments: _____

Evaluated by (name/title): _____ Date: _____

Iowa Site Inventory Form Continuation Sheet

Page 1

<u>Washington County Jail and Sheriff's Residence</u>	<u>Washington</u>
Name of Property	County
<u>221 West Second Street</u>	<u>Washington</u>
Address	City

This form was prepared as part of a research/survey/nomination project in 2011-2012 funded by a HRDP grant from the State Historical Society of Iowa for the nomination of the Washington Downtown Historic District. The project was primarily structured to develop the nomination for the downtown, with additional research on each building documented on an Iowa Site Inventory form. The information below is taken from the table in the August 2012 draft of the nomination, with additional information documented on the property and photographs in the following sections.

Washington County Jail and Sheriff's Residence - 221 W. Second St - State #92-00585 - Map #13 ~ 2
contributing buildings (A and C) - 1965-66, also 1940s garage - modern (1960s)

Historic information:

(1880s-1960s - earlier sheriff's residence and jail)

1965-66 - new county jail and deputy sheriff's residence constructed - open house on 5-21-66

1976 - remodeled for joint county/city communications center - Public Safety Center

2012 - Communications Center

Architectural information:

Height: 1 story

Walls: brick

Windows: rectangular single light windows

Architectural details: horizontal modern lines with overhanging roof

Architect/Builder: Powers and Associates (architect, Iowa City)

Modifications: Historic: -; Non-historic: 1976 - residence (east) portion remodeled for joint sheriff/police offices and communication center

Garage - 1 story tile block, 3 single-car garage doors on south - built in 1940s

7. Narrative Description

This one-story building has a poured concrete foundation and walls constructed of concrete block with red brick veneer. Main entry is centered on the north (W. Second) side of the building. The east side of the building consists of offices and the communications center. Modern windows have replaced the originals. The west side of the building holds the jail with long, narrow, grated windows running around the top. There is a fire escape door on both the south and west sides of the jail. The flat roof extends with wide eaves trimmed in aluminum out from the building, giving the building a style characteristic of its 1960s construction.

A one-story tile block garage sits behind the jail at the southeast corner of the property. It was built 15-20 years prior to the new jail. It has three single-car garage doors on the south side.

Iowa Site Inventory Form Continuation Sheet

Page 2

<u>Washington County Jail and Sheriff's Residence</u>	<u>Washington</u>
Name of Property	County
<u>221 West Second Street</u>	<u>Washington</u>
Address	City

8. Narrative Statement of Significance

The Washington County Jail and Sheriff's Residence appears to contribute historically and architecturally to the Washington Downtown Historic District. The tile block garage along the alley also contributes to the historic district.

Sanborn Maps from 1885 to 1943 show an older dwelling (sheriff's residence) with the jail attached to the rear. The lot to the east has a one-and-one-half-story garage built in the 1910s on it. This garage was replaced with the current tile block garage after 1943. It was built here 15-20 years prior to the construction of the new jail.

This old jail and sheriff residence did not pass inspections by the early 1960s, condemned by the county grand jurors. Thus, plans were made for a new building, with architects Power and Associates of Iowa City selected for the design. The design was for a modern building, with a jail wing on the west and the deputy sheriff's residence on the east. On November 3, 1964, a \$110,000 bond issue was voted on and passed by the county residents. Final plans were made and bids were advertised. However, the bids initially came in at a combined total of \$127,000 and were rejected. Bids were finally awarded in May 1965 for a total of \$102,688: general to H. Eugene Smith of Mt. Pleasant for \$57,111, mechanical to Carson Plumbing and Heating for \$19,979, electrical to Robert Miler for \$3,365, and jail equipment to Southern Steel of San Antonio, TX for \$22,233. On Saturday May 21, 1966, an open house was held for the new jail and deputy sheriff's residence. It was described as an attractive modern building on the exterior and a hard jail on the interior. The residence portion was noted as well decorated by the sheriff's wife ("Proposed New County Jail Building," *Washington Evening Journal*, October 27, 1964, 4?; "Supervisors reject bids on new jail," *Washington Evening Journal*, March 24, 1965, 1; "The New Jail," *Washington Evening Journal*, May 23, 1966, 4).

In 1974, the sheriff's office moved from the courthouse into this building. In 1976, the building underwent an extensive interior remodel to convert the living quarters into offices for both the sheriff and the Washington Chief of Police (Ken Bauer), along with a joint radio communications center. The police retained separate identity, paying rent to the county for the office space. The new Public Safety Center was opened in April 1976. ("Public Safety center new," *Bicentennial Edition, Evening Journal*, July 1, 1976, 17; Fisher 1978: 324). In 1977, a new radio tower and communications console were installed, and new communications equipment was installed in 1980.

Iowa Site Inventory Form Continuation Sheet

Page 3

<u>Washington County Jail and Sheriff's Residence</u>	<u>Washington</u>
Name of Property	County
<u>221 West Second Street</u>	<u>Washington</u>
Address	City

9. Major Bibliographical References

City/Telephone Directories, Washington. Various publishers, various dates. Available at the Washington Public Library.

Deed Records, Transfer Books, Auditor's Office, Washington County Courthouse, Washington, Iowa.

Newspaper advertisements, various years/dates, on microfilm at Washington Public Library:

Washington Evening Journal

Washington Gazette

Washington Press

Sanborn Map Company. "Washington, Iowa," Sanborn fire insurance maps. Pelham, NY: Sanborn Map Company, 1885, 1892, 1897, 1902, 1909, 1917, 1931, 1943.

Iowa Site Inventory Form Continuation Sheet

Page 4

Washington County Jail and Sheriff's Residence

Washington

Name of Property

County

221 West Second Street

Washington

Address

City

Location map

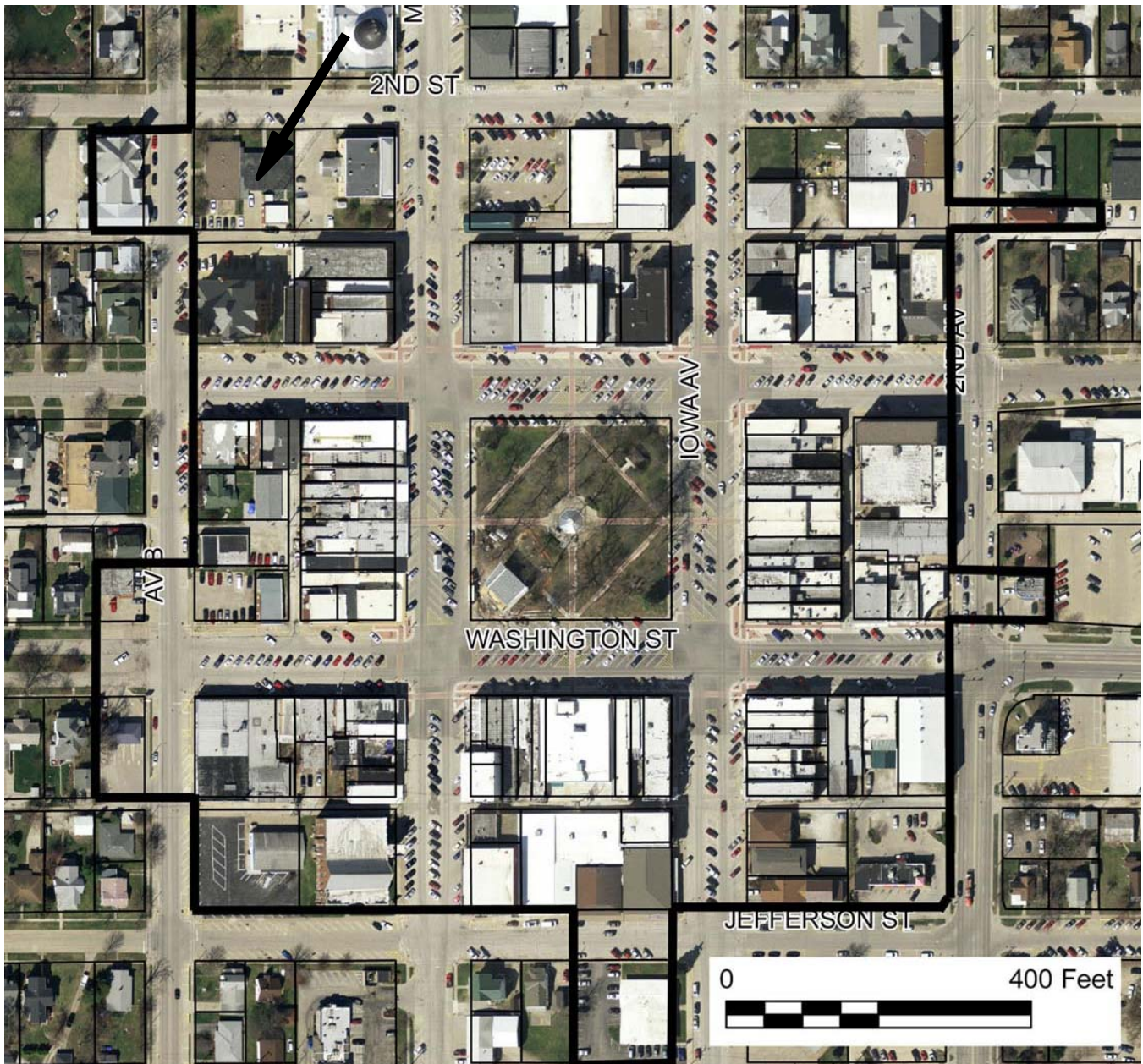

2009 aerial photograph (Washington County) – line indicates survey/research area boundary

Iowa Site Inventory Form Continuation Sheet

Page 5

Washington County Jail and Sheriff's Residence

Washington

Name of Property

County

221 West Second Street

Washington

Address

City

Building/site plan (from assessor's website)



Iowa Site Inventory Form Continuation Sheet

Page 6

<u>Washington County Jail and Sheriff's Residence</u>	<u>Washington</u>
Name of Property	County
<u>221 West Second Street</u>	<u>Washington</u>
Address	City

Historic images

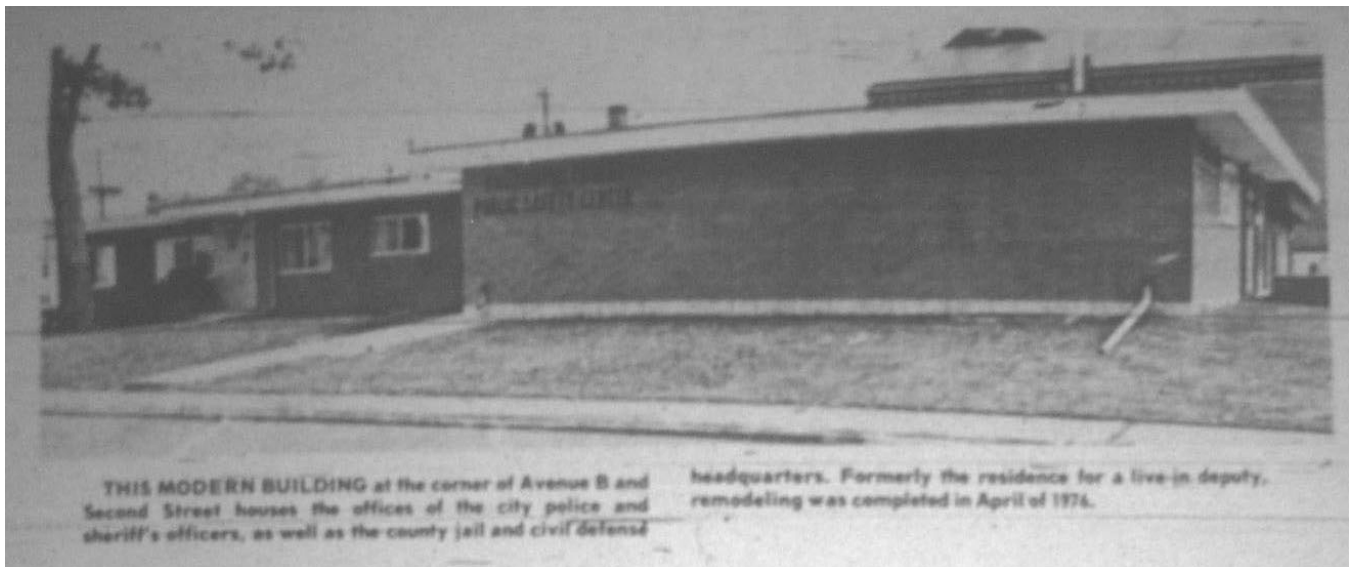

Evening Journal, July 1, 1976, p16

Iowa Site Inventory Form Continuation Sheet

Page 7

Washington County Jail and Sheriff's Residence

Washington

Name of Property

County

221 West Second Street

Washington

Address

City

Digital photographs



Photograph 92-00585-001 - East and north elevations, looking southwest (McCarley, November 15, 2011).

Iowa Site Inventory Form Continuation Sheet

Page 8

Washington County Jail and Sheriff's Residence

Washington

Name of Property

County

221 West Second Street

Washington

Address

City



Photograph 92-00585-002 - North elevation, looking south (McCarley, November 15, 2011).

Iowa Site Inventory Form Continuation Sheet

Page 9

Washington County Jail and Sheriff's Residence

Washington

Name of Property

County

221 West Second Street

Washington

Address

City



Photograph 92-00585-003 - East and north elevations of east/office section, looking southwest (McCarley, November 15, 2011).

Iowa Site Inventory Form
Continuation Sheet

Page 10

Washington County Jail and Sheriff's Residence

Washington

Name of Property

County

221 West Second Street

Washington

Address

City



Photograph 92-00585-004 - East and north elevations of west/jail section, looking southwest (McCarley, November 15, 2011).

**Iowa Site Inventory Form
Continuation Sheet**

Page 11

Washington County Jail and Sheriff's Residence

Washington

Name of Property

County

221 West Second Street

Washington

Address

City



Photograph 92-00585-005 - North and west elevations, looking southeast (McCarley, November 15, 2011).

Iowa Site Inventory Form Continuation Sheet

Page 12

Washington County Jail and Sheriff's Residence

Washington

Name of Property

County

221 West Second Street

Washington

Address

City



Photograph 92-00585-006 - South elevation with garage at right, looking north (McCarley, November 15, 2011).

Iowa Site Inventory Form Continuation Sheet

Page 13

Washington County Jail and Sheriff's Residence

Washington

Name of Property

County

221 West Second Street

Washington

Address

City



Photograph 92-00585-007 - South elevation of east section, looking northwest (McCarley, November 15, 2011).

Iowa Department of Cultural Affairs
State Historical Society of Iowa
Iowa Site Inventory Form
Continuation Sheet

Site Number 92-00585
Related District Number 92-00349

Page 14

Washington County Jail and Sheriff's Residence

Name of Property

Washington

County

221 West Second Street

Address

Washington

City



Photograph 92-00585-008 - Tile block garage, looking northeast (McCarley, November 15, 2011).

**Iowa Site Inventory Form
Continuation Sheet**

Page 15

Washington County Jail and Sheriff's Residence

Washington

Name of Property

County

221 West Second Street

Washington

Address

City



Photograph 92-00585-009 - Tile block garage, looking southwest (McCarley, November 15, 2011).