

# Site Inventory Form

State Historical Society of Iowa

(November 2005)

State Inventory No. 92-00505

New  Supplemental

Part of a district with known boundaries (enter inventory no.) 92-00349

Relationship:  Contributing  Noncontributing

Contributes to a potential district with yet unknown boundaries

National Register Status:(any that apply)  Listed  De-listed  NHL  DOE

9-Digit SHPO Review & Compliance (R&C) Number \_\_\_\_\_

Non-Extant (enter year) \_\_\_\_\_

## 1. Name of Property

historic name Farm Bureau office

other names/site number Downtown Survey Map # DT-048

## 2. Location

street & number 210 North Iowa

city or town Washington

vicinity, county Washington

Legal Description: (If Rural) Township Name \_\_\_\_\_ Township No. \_\_\_\_\_ Range No. \_\_\_\_\_ Section \_\_\_\_\_ Quarter of Quarter \_\_\_\_\_

(If Urban) Subdivision Original Plat Block(s) 2 Lot(s) south 32' of north 40' of lot 5

## 3. State/Federal Agency Certification [Skip this Section]

## 4. National Park Service Certification [Skip this Section]

## 5. Classification

Category of Property (Check only one box)

- building(s)
- district
- site
- structure
- object

### Number of Resources within Property

If Non-Eligible Property

Enter number of:

— buildings  
 — sites  
 — structures  
 — objects  
 — Total

If Eligible Property, enter number of:

Contributing	Noncontributing
<u>1</u>	—
—	—
—	—
—	—
<u>1</u>	—

Name of related project report or multiple property study (Enter "N/A" if the property is not part of a multiple property examination).

Title \_\_\_\_\_

Historical Architectural Data Base Number \_\_\_\_\_

## 6. Function or Use

Historic Functions (Enter categories from instructions)

02A01 Office Building 02B04 Insurance Office

Current Functions (Enter categories from instructions)

02B03 Law Office

## 7. Description

Architectural Classification (Enter categories from instructions)

09F05: Commercial / brick front

Materials (Enter categories from instructions)

foundation \_\_\_\_\_

walls (visible material) 03 Brick 05E Aluminum

roof \_\_\_\_\_

other \_\_\_\_\_

Narrative Description ( SEE CONTINUATION SHEETS, WHICH MUST BE COMPLETED)

## 8. Statement of Significance

Applicable National Register Criteria (Mark "x" representing your opinion of eligibility after applying relevant National Register criteria)

- Yes  No  More Research Recommended
- Yes  No  More Research Recommended
- Yes  No  More Research Recommended
- Yes  No  More Research Recommended

- A Property is associated with significant events.
- B Property is associated with the lives of significant persons.
- C Property has distinctive architectural characteristics.
- D Property yields significant information in archeology or history.

County Washington Address 210 North Iowa  
City Washington

Site Number 92-00505  
District Number 92-00349

**Criteria Considerations**

- A Owned by a religious institution or used for religious purposes.
- B Removed from its original location.
- C A birthplace or grave.
- D A cemetery
- E A reconstructed building, object, or structure.
- F A commemorative property.
- G Less than 50 years of age or achieved significance within the past 50 years.

**Areas of Significance** (Enter categories from instructions)

05: Commerce

**Significant Dates**

Construction date 1959  check if circa or estimated date  
Other dates, including renovation

**Significant Person**

(Complete if National Register Criterion B is marked above)

**Architect/Builder**

Architect

Builder

Earl Wood

**Narrative Statement of Significance**  SEE CONTINUATION SHEETS, WHICH MUST BE COMPLETED

**9. Major Bibliographical References**

Bibliography  See continuation sheet for citations of the books, articles, and other sources used in preparing this form

**10. Geographic Data**

**UTM References (OPTIONAL)**

Zone	Easting	Northing	Zone	Easting	Northing
1	_____	_____	2	_____	_____
3	_____	_____	4	_____	_____

See continuation sheet for additional UTM references or comments

**11. Form Prepared By**

name/title Michael Kramme & Carol Ray Rebecca L. McCarley, consultant, Davenport  
organization Washington Historic Preservation Commission date April 3, 2012  
street & number City Hall – 215 E. Washington St telephone 319-653-6584  
city or town Washington state Iowa zip code 52353

**ADDITIONAL DOCUMENTATION** (Submit the following items with the completed form)

**FOR ALL PROPERTIES**

- Map:** showing the property's location in a town/city or township.
- Site plan:** showing position of buildings and structures on the site in relation to public road(s).
- Photographs:** representative black and white photos. If the photos are taken as part of a survey for which the Society is to be curator of the negatives or color slides, a photo/catalog sheet needs to be included with the negatives/slides and the following needs to be provided below on this particular inventory site:

Roll/slide sheet #	_____	Frame/slot #	_____	Date Taken	_____
Roll/slide sheet #	_____	Frame/slot #	_____	Date Taken	_____
Roll/slide sheet #	_____	Frame/slot #	_____	Date Taken	_____

- See continuation sheet or attached *photo & slide catalog sheet* for list of photo roll or slide entries.
- Photos/illustrations without negatives are also in this site inventory file.

**FOR CERTAIN KINDS OF PROPERTIES, INCLUDE THE FOLLOWING AS WELL**

- Farmstead & District:** (List of structures and buildings, known or estimated year built, and contributing or noncontributing status)
- Barn:**
  - A sketch of the frame/truss configuration in the form of drawing a typical middle bent of the barn.
  - A photograph of the loft showing the frame configuration along one side.
  - A sketch floor plan of the interior space arrangements along with the barn's exterior dimensions in feet.

**State Historic Preservation Office (SHPO) Use Only Below This Line**

Concur with above survey opinion on National Register eligibility:  Yes  No  More Research Recommended  
 This is a locally designated property or part of a locally designated district.

Comments: \_\_\_\_\_

Evaluated by (name/title): \_\_\_\_\_ Date: \_\_\_\_\_

# Iowa Site Inventory Form Continuation Sheet

Page 1

---

<u>Farm Bureau</u>	<u>Washington</u>
Name of Property	County
<u>210 North Iowa</u>	<u>Washington</u>
Address	City

---

*This form was prepared as part of a research/survey/nomination project in 2011-2012 funded by a HRDP grant from the State Historical Society of Iowa for the nomination of the Washington Downtown Historic District. The project was primarily structured to develop the nomination for the downtown, with additional research on each building documented on an Iowa Site Inventory form. The information below is taken from the table in the August 2012 draft of the nomination, with additional information documented on the property and photographs in the following sections.*

**Farm Bureau office - 210 N. Iowa Avenue** - State #92-00505 - Map #34 ~ 1 contributing building (A) - 1959 - 1950s commercial modern

Historic information:

- 1959-1960s - Farm Bureau - insurance and service
- 1972 - Helsher Insurance, 1976 - Production Credit Association
- 2012 - law office of Crystal Arthur

Architectural information:

- Height: 1 story
- Walls: brick veneer on concrete block
- Storefront: -
- Windows: -
- Architectural details: brick veneer façade
- Architect/Builder: Earl R. Wood (contractor)
- Modifications: -

## 7. Narrative Description

The commercial building at 210 North Iowa is a one-story structure with a brick facade and sides clad in aluminum siding. It sits on a concrete foundation, and it has a asphalt shingle roof. The facade has a center entry with sidelight, with one large single-light window on each side. The south and alley (north) sides each have three horizontal single light windows.

## 8. Narrative Statement of Significance

The Farm Bureau building appear to contribute historically and architecturally to the Washington Downtown Historic District.

The building sits on the north portion of the lot associated with the earlier house at 102 E. 2nd Street. The entire lot transferred from Cora B. Wilson's estate to Dora E. Bolar on May 15, 1958. She then sold it to Earl R. Wood on January 2, 1959. Wood was a local contractor and likely then built this building. The assessor also lists a construction date of 1959. This history of Immanuel Lutheran Church notes that they formed in September 1960 and met in the old Farm Bureau building, so this new building appears to have been complete by then (Fisher 1978: 176). The 1964 city directory lists Farm

# Iowa Site Inventory Form Continuation Sheet

Page 2

---

<u>Farm Bureau</u>	<u>Washington</u>
Name of Property	County
<u>210 North Iowa</u>	<u>Washington</u>
Address	City

---

Bureau Insurance and Farm Bureau Services at 210 N. Iowa. Wood owned the building until his death in 1978. He also built a similar building at 108 W. Jefferson in 1963.

Tenants have included: Ohio National Life Insurance Production Credit (1959 phone directory), Helsher Insurance (1972 phone directory), Crystal Arthur attorney / Vittetoe Pork Office / Washington Bookkeeping Service (2009 city directory). It is currently the law office of Crystal Arthur.

## 9. Major Bibliographical References

City/Telephone Directories, Washington. Various publishers, various dates. Available at the Washington Public Library.

Deed Records, Transfer Books, Auditor's Office, Washington County Courthouse, Washington, Iowa.

Newspaper advertisements, various years/dates, on microfilm at Washington Public Library:

*Washington Evening Journal*  
*Washington Gazette*  
*Washington Press*

Sanborn Map Company. "Washington, Iowa," Sanborn fire insurance maps. Pelham, NY: Sanborn Map Company, 1885, 1892, 1897, 1902, 1909, 1917, 1931, 1943.

Iowa Department of Cultural Affairs  
State Historical Society of Iowa  
**Iowa Site Inventory Form**  
**Continuation Sheet**

Site Number 92-00505  
Related District Number 92-00349

Page 3

Name of Property	Farm Bureau	County	Washington
Address	210 North Iowa	City	Washington

**Location map**

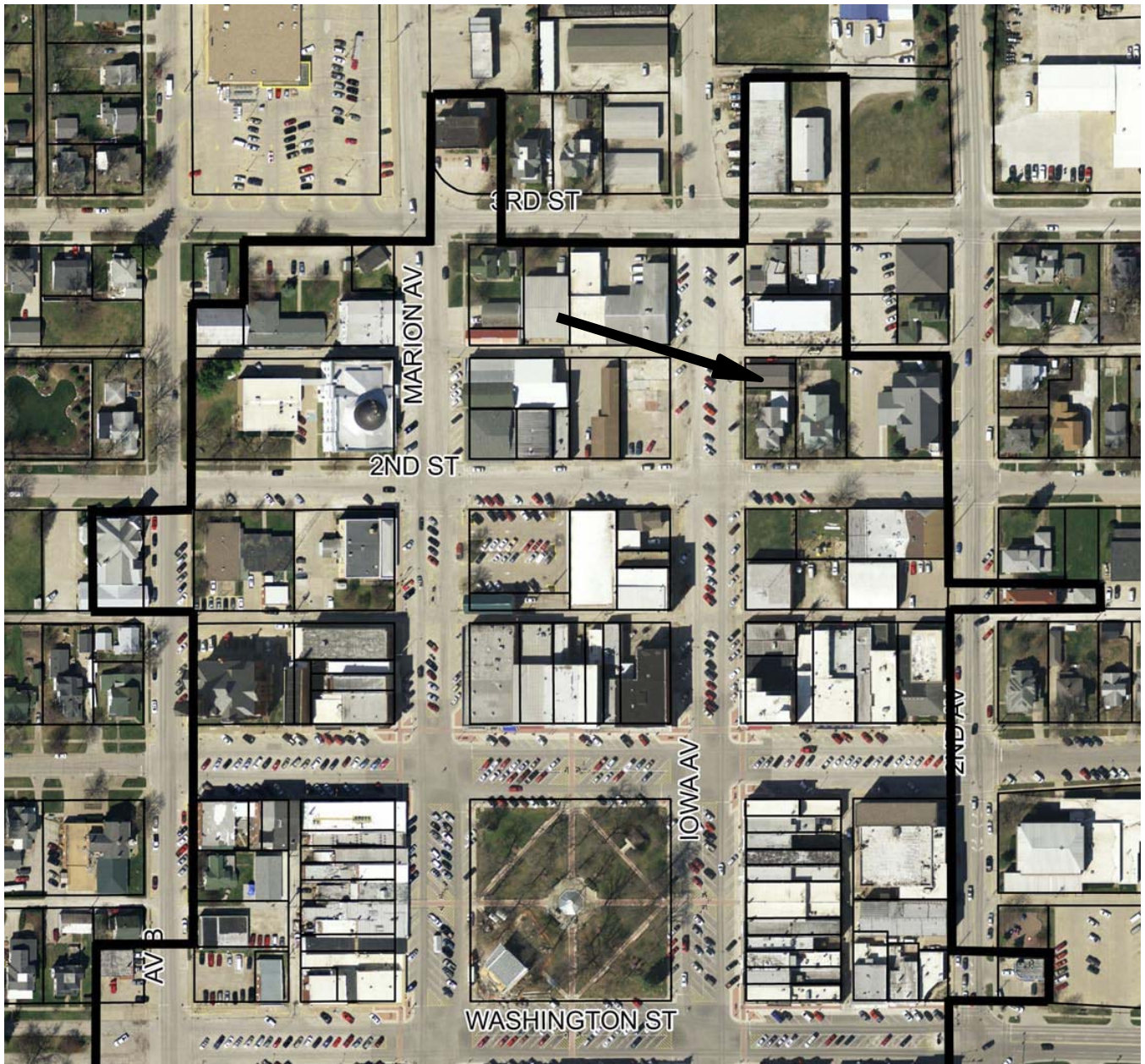

*2009 aerial photograph (Washington County) – line indicates survey/research area boundary*

# Iowa Site Inventory Form Continuation Sheet

Site Number 92-00505

Related District Number 92-00349

Page 4

---

<u>Farm Bureau</u> Name of Property	<u>Washington</u> County
<u>210 North Iowa</u> Address	<u>Washington</u> City

---

### Building plan (from assessor's website)

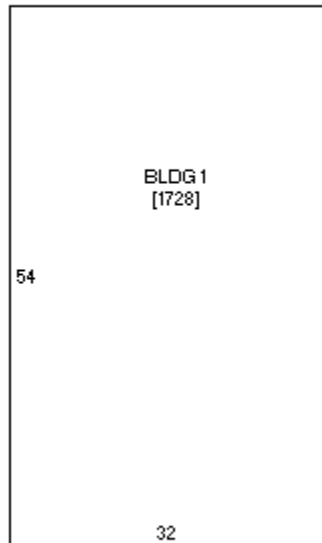

### Historic images

none identified

# Iowa Site Inventory Form Continuation Sheet

Page 5

Farm Bureau  
Name of Property

Washington  
County

210 North Iowa  
Address

Washington  
City

## Digital photographs



Photograph 92-00505-001 - West and south elevations, looking northeast (McCarley, September 20, 2011)

**Iowa Site Inventory Form  
Continuation Sheet**

Page 6

Farm Bureau  
Name of Property

Washington  
County

210 North Iowa  
Address

Washington  
City



Photograph 92-00505-002 - North and west elevations, looking southeast (McCarley, September 20, 2011)