

Site Inventory Form

State Historical Society of Iowa

(November 2005)

State Inventory No. 92-00497

New Supplemental

Part of a district with known boundaries (enter inventory no.) 92-00349

Relationship: Contributing Noncontributing

Contributes to a potential district with yet unknown boundaries

National Register Status:(any that apply) Listed De-listed NHL DOE

9-Digit SHPO Review & Compliance (R&C) Number _____

Non-Extant (enter year) _____

1. Name of Property

historic name Livingston, Day, Kehoe, Meeker, & Bates Law Office

other names/site number Downtown Survey Map # DT-006

2. Location

street & number 112 S. Avenue B

city or town Washington

vicinity, county Washington

Legal Description: (If Rural) Township Name _____ Township No. _____ Range No. _____ Section _____ Quarter of Quarter _____

(If Urban) Subdivision Original Plat Block(s) 12 Lot(s) Lot 6 – N 60'

3. State/Federal Agency Certification [Skip this Section]

4. National Park Service Certification [Skip this Section]

5. Classification

Category of Property (Check only one box)

- building(s)
- district
- site
- structure
- object

Number of Resources within Property

If Non-Eligible Property

If Eligible Property, enter number of:

Enter number of:

Contributing

Noncontributing

— buildings

— sites

— structures

— objects

— Total

1

—

—

—

1

— buildings

— sites

— structures

— objects

— Total

Name of related project report or multiple property study (Enter "N/A" if the property is not part of a multiple property examination).

Title

Historical Architectural Data Base Number

6. Function or Use

Historic Functions (Enter categories from instructions)

Current Functions (Enter categories from instructions)

02B03 Commerce / professional / law office

02B03 Commerce / professional / law office

7. Description

Architectural Classification (Enter categories from instructions)

Materials (Enter categories from instructions)

09F05 Commerce: brick front

foundation _____

walls (visible material) 03 Brick & 10A Concrete block

roof _____

other _____

Narrative Description (SEE CONTINUATION SHEETS, WHICH MUST BE COMPLETED)

8. Statement of Significance

Applicable National Register Criteria (Mark "x" representing your opinion of eligibility after applying relevant National Register criteria)

- Yes No More Research Recommended
- Yes No More Research Recommended
- Yes No More Research Recommended
- Yes No More Research Recommended

- A Property is associated with significant events.
- B Property is associated with the lives of significant persons.
- C Property has distinctive architectural characteristics.
- D Property yields significant information in archeology or history.

County Washington Address 106-108 S. Avenue B
City Washington

Site Number 92-00496
District Number 92-00349

Criteria Considerations

- A Owned by a religious institution or used for religious purposes.
- B Removed from its original location.
- C A birthplace or grave.
- D A cemetery
- E A reconstructed building, object, or structure.
- F A commemorative property.
- G Less than 50 years of age or achieved significance within the past 50 years.

Areas of Significance (Enter categories from instructions)

Significant Dates

Construction date 1965-66 check if circa or estimated date
Other dates, including renovation _____

Significant Person

(Complete if National Register Criterion B is marked above)

Architect/Builder

Architect _____

Builder _____

Narrative Statement of Significance (SEE CONTINUATION SHEETS, WHICH MUST BE COMPLETED)

9. Major Bibliographical References

Bibliography See continuation sheet for citations of the books, articles, and other sources used in preparing this form

10. Geographic Data

UTM References (OPTIONAL)

Zone	Easting	Northing	Zone	Easting	Northing
1	_____	_____	2	_____	_____
3	_____	_____	4	_____	_____

See continuation sheet for additional UTM references or comments

11. Form Prepared By

name/title Mary Patterson, Chair Rebecca L. McCarley, consultant, Davenport
organization Washington Historic Preservation Commission date May 10, 2012
street & number City Hall – 215 E. Washington St telephone 319-653-6584
city or town Washington state Iowa zip code 52353

ADDITIONAL DOCUMENTATION (Submit the following items with the completed form)

FOR ALL PROPERTIES

- Map:** showing the property's location in a town/city or township.
- Site plan:** showing position of buildings and structures on the site in relation to public road(s).
- Photographs:** representative black and white photos. If the photos are taken as part of a survey for which the Society is to be curator of the negatives or color slides, a photo/catalog sheet needs to be included with the negatives/slides and the following needs to be provided below on this particular inventory site:

Roll/slide sheet #	_____	Frame/slot #	_____	Date Taken	_____
Roll/slide sheet #	_____	Frame/slot #	_____	Date Taken	_____
Roll/slide sheet #	_____	Frame/slot #	_____	Date Taken	_____

- See continuation sheet or attached *photo & slide catalog sheet* for list of photo roll or slide entries.
- Photos/illustrations without negatives are also in this site inventory file.

FOR CERTAIN KINDS OF PROPERTIES, INCLUDE THE FOLLOWING AS WELL

- Farmstead & District:** (List of structures and buildings, known or estimated year built, and contributing or noncontributing status)
- Barn:**
 - A sketch of the frame/truss configuration in the form of drawing a typical middle bent of the barn.
 - A photograph of the loft showing the frame configuration along one side.
 - A sketch floor plan of the interior space arrangements along with the barn's exterior dimensions in feet.

State Historic Preservation Office (SHPO) Use Only Below This Line

Concur with above survey opinion on National Register eligibility: Yes No More Research Recommended
 This is a locally designated property or part of a locally designated district.

Comments: _____

Evaluated by (name/title): _____ Date: _____

Iowa Site Inventory Form Continuation Sheet

Page 1

<u>Livingston, Day, Kehoe, Meeker, & Bates Law Office</u>	<u>Washington</u>
Name of Property	County
<u>112 S. Avenue B</u>	<u>Washington</u>
Address	City

This form was prepared as part of a research/survey/nomination project in 2011-2012 funded by a HRDP grant from the State Historical Society of Iowa for the nomination of the Washington Downtown Historic District. The project was primarily structured to develop the nomination for the downtown, with additional research on each building documented on an Iowa Site Inventory form. The information below is taken from the table in the August 2012 draft of the nomination, with additional information documented on the property and photographs in the following sections.

Livingston, Day, Meeker, Kehoe & Bates Law Office - 112 S. Avenue B - State #92-00497 - Map #67 ~ 1 contributing building (A and C) - 1965-66 - 1960s commercial modern

Historic information:

(1935-36 - house at 112, Pleasant Inn - restaurant - 114)

1965-66 - construction of Livingston, Day, Meeker, Kehoe & Bates law offices

2012 - Day, Meeker, Lamping, Schlegel & Salazar Law offices

Architectural information:

Height: 1 story

Walls: concrete block

Storefront: -

Windows: -

Architectural details: light brick façade, multi-light windows, pent roof with brackets

Architect/Builder: -

Modifications: -

7. Narrative Description

This is a one story concrete block office building with a brick veneer facade. The centrally located primary entry is a six panel wood door with three-light sidelights with a wood bulkhead. On either side of the entry is a large divided light windows with three rows of five lights, a brick sill, and faux shutters. A brick planter, capped with slate, is located below each window and extends to the entry sidewalk. There is a shed-roof wood awning over the planters, windows, and entry door which has large wood brackets at each end. The north facade is made of concrete block and has three small two-light windows. The south facade, also concrete block, has four similar windows except the one nearest the front of the building has concrete block infill indicating the window may have originally been twice as wide. The top of the building walls has a simple concrete cap.

8. Narrative Statement of Significance

The law office building appears to contribute historically and architecturally to the Downtown Washington Historic District. This is the last of three law offices within a block to build or significantly remodel a building from 1957 to the middle of the 1960s. The construction of this building continues this trend in the historic district, and the period of significance extends through the completion of this building.

Iowa Site Inventory Form Continuation Sheet

Page 2

Livingston, Day, Kehoe, Meeker, & Bates Law Office

Washington

Name of Property

County

112 S. Avenue B

Washington

Address

City

The 1943 Sanborn map shows a house, garage, and small restaurant on Lot 6. The north 60' of Lot 6 was purchased in March 1965 by Robert Day, and the building was completed by 1966, per the assessor. It originally housed Livingston, Day, Meeker, Kehoe & Bates law offices. City directories show that S.W. Livingston previously practiced for many years at 204 W. Main Street. In 1955, Livingston & Day Attorneys welcomed Everett Meeker to their practice. In 1964, Livingston, Day, & Bates are listed at this previous location. Louis Kehoe practiced for many years in Wellman, opening a second office in Washington in 1937. The Kehoe Law Office is listed at 103 1/3 N. Marion through 1964. Thus, the construction of this building appears to be the result of the continued growth of the law office.

Currently, it houses Day, Meeker, Lamping, Schlegel & Salazar Law offices.

9. Major Bibliographical References

City/Telephone Directories, Washington. Various publishers, various dates. Available at the Washington Public Library.

Deed Records, Transfer Books, Auditor's Office, Washington County Courthouse, Washington, Iowa.

Newspaper advertisements, various years/dates, on microfilm at Washington Public Library:

Washington Evening Journal

Washington Gazette

Washington Press

Sanborn Map Company. "Washington, Iowa," Sanborn fire insurance maps. Pelham, NY: Sanborn Map Company, 1885, 1892, 1897, 1902, 1909, 1917, 1931, 1943.

Iowa Site Inventory Form Continuation Sheet

Page 3

Livingston, Day, Kehoe, Meeker, & Bates Law Office

Washington

Name of Property

County

112 S. Avenue B

Washington

Address

City

Location map

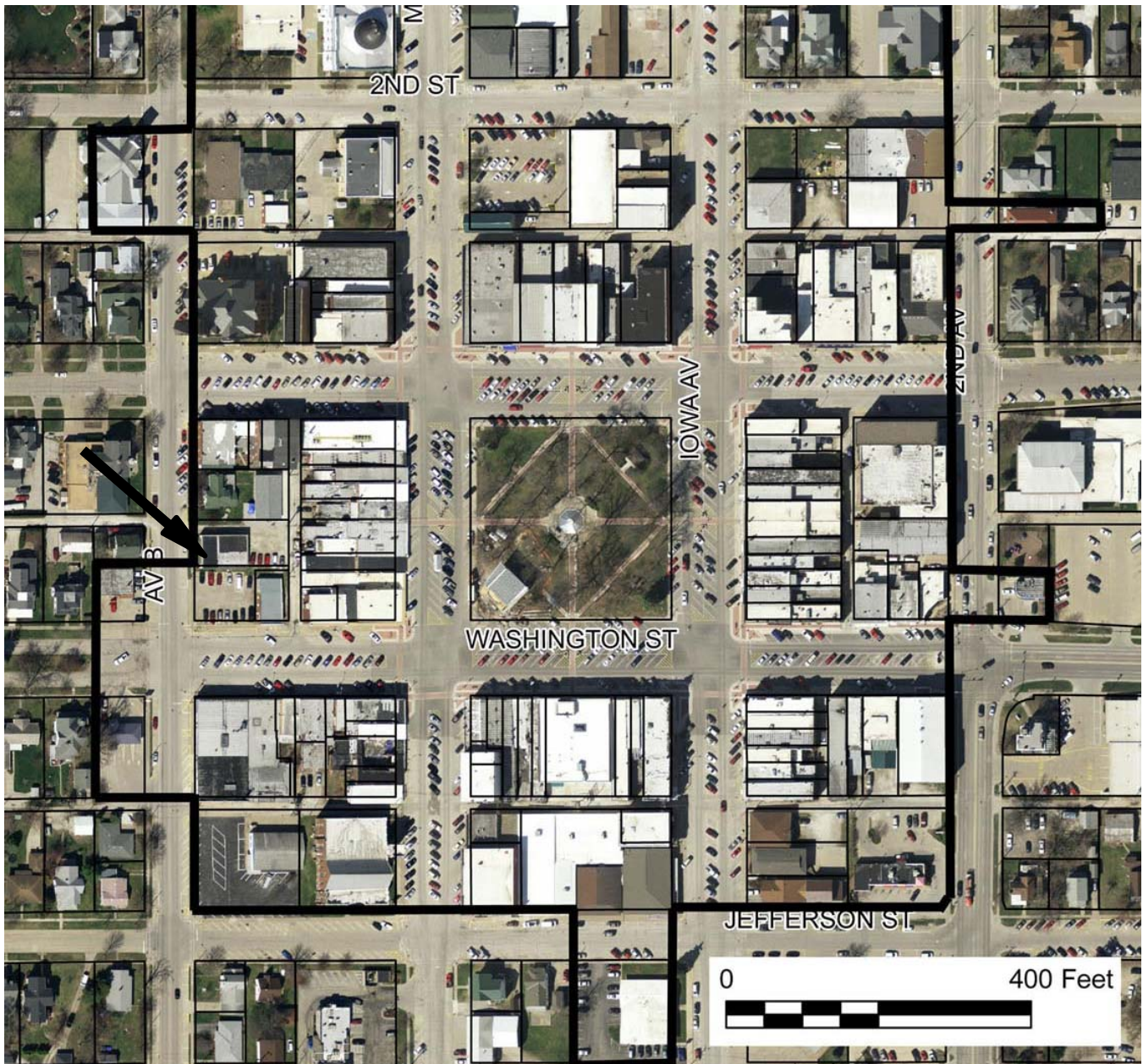

2009 aerial photograph (Washington County) – line indicates survey/research area boundary

Iowa Site Inventory Form Continuation Sheet

Page 4

Name of Property	Livingston, Day, Kehoe, Meeker, & Bates Law Office	County	Washington
Address	112 S. Avenue B	City	Washington

Building plan (from assessor's website)

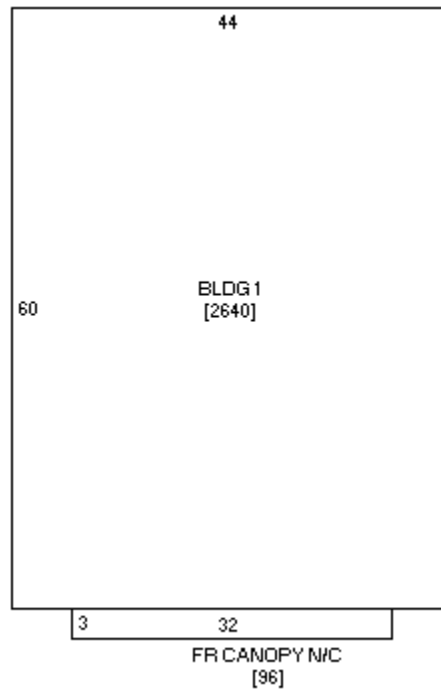

Historic images

none identified

Iowa Site Inventory Form Continuation Sheet

Site Number 92-00497

Related District Number 92-00349

Page 5

Livingston, Day, Kehoe, Meeker, & Bates Law Office

Name of Property

Washington

County

112 S. Avenue B

Address

Washington

City

Digital photographs



Photograph 92-00497-001 - West and south elevations, looking northeast (McCarley, September 20, 2011)

Iowa Site Inventory Form Continuation Sheet

Page 6

Livingston, Day, Kehoe, Meeker, & Bates Law Office

Washington

Name of Property

County

112 S. Avenue B

Washington

Address

City



Photograph 92-00497-002 - North and west elevations, looking southeast (McCarley, September 20, 2011)